

LoFric[®] Plus



Connector has different colours depending on the diameter of the catheter.



Catheter tube with Urotonic[™] Surface Technology. Gives the lowest friction during insertion and withdrawal.

Smooth catheter eyes where the urine runs through.

Intended Use

- Hydrophilic single use catheter for every-day use or for health care use
- Intermittent catheterisation
- Bladder emptying

Sterilisation & Shelf Life

All catheters are sterilised by ethylene oxide gas. Information about the recommended best-before date is printed on the package.

Package

25 catheters per carton
4 cartons per shipping box

Material Composition

Hydrophilic surface coating: Polyvinyl pyrrolidone (PVP) and table salt (NaCl)

Catheter: medical grade polyvinyl chloride (PVC)

Item sterile package:

Lacquered paper, laminated film of polypropylene (PP) and polyethylene (PE)

Product Range

Ref.no	Type	Length	Size
90 40 00	LoFric [®] Plus Nelaton	40 cm	CH 10
90 42 00	LoFric [®] Plus Nelaton	40 cm	CH 12
90 44 00	LoFric [®] Plus Nelaton	40 cm	CH 14
90 46 00	LoFric [®] Plus Nelaton	40 cm	CH 16
90 48 00	LoFric [®] Plus Nelaton	40 cm	CH 18
99 36 00	LoFric [®] Plus Paediatric	30 cm	CH 06
99 38 00	LoFric [®] Plus Paediatric	30 cm	CH 08
99 40 00	LoFric [®] Plus Paediatric	30 cm	CH 10
94 38 00	LoFric [®] Plus Female	20 cm	CH 08
94 40 00	LoFric [®] Plus Female	20 cm	CH 10
94 42 00	LoFric [®] Plus Female	20 cm	CH 12
94 44 00	LoFric [®] Plus Female	20 cm	CH 14
94 46 00	LoFric [®] Plus Female	20 cm	CH 16
94 48 00	LoFric [®] Plus Female	20 cm	CH 18
98 40 00	LoFric [®] Plus Female	15 cm	CH 10
98 42 00	LoFric [®] Plus Female	15 cm	CH 12
98 44 00	LoFric [®] Plus Female	15 cm	CH 14
98 46 00	LoFric [®] Plus Female	15 cm	CH 16

Instructions

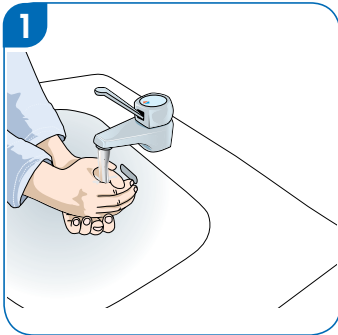

1. Wash your hands with soap and water.

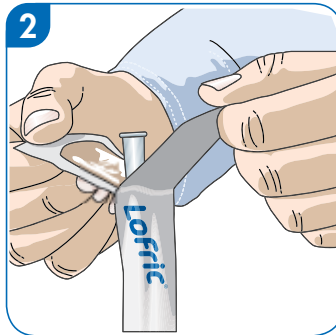

2. Open the package by pulling the flaps apart 5–6 cm.

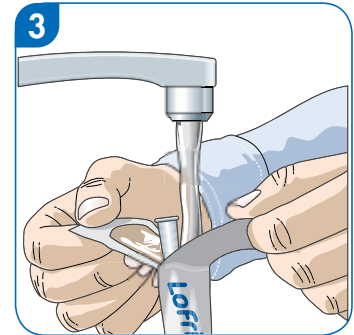

3. Fill with water directly into the package. Fill nearly to the top. Drinking water, sterile water or sodium chloride solution is OK.

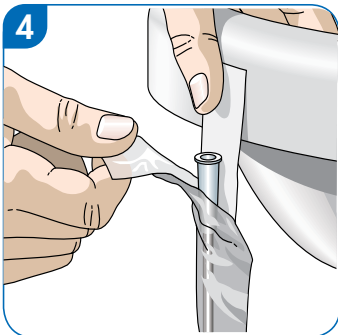

4. The package has an adhesive sticker. Remove the blue protective strip and attach the package to a dry surface.

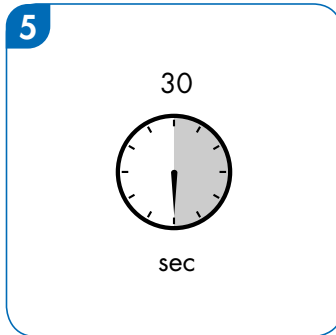

5. Immerse the catheter for 30 seconds while you prepare yourself. Carry out the catheterisation as soon as possible.